

SPECIFICATION

Range: **FLOAT**

Design: **Alberto Meda, Francesco Meda**

“Snowsound Technology” sound-absorbing element suspended from the ceiling with cables.

Panel description:

Panel with convex back side and flat front side, thickness 36 mm consisting of variable density polyester fibre filling, decreasing towards the core of the panel, covered on both sides with Trevira CS® polyester fabric firmly applied to the padding.

The panel is characterised by the rigid edge obtained by machining the panel itself, without the presence of any supporting and stiffening frame.

The panel has an **Italian Class1** fire reaction and **Euroclass B-s2, d0**.

The panel is **Greenguard Gold** certified, which validates its low VOC emission and its contribution to the quality of the indoor environment.

The panel is **100% recyclable** and has no detectable formaldehyde content according to UNI EN 717-2. It does not contain felts or other organic materials that are hardly recyclable.

The panel has been tested in reverberation chamber according to UNI EN ISO 354 and obtained “**Acoustic Absorption Class A**”, in accordance with UNI EN ISO 11654.

Panel dimension:

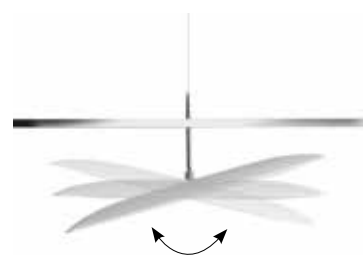
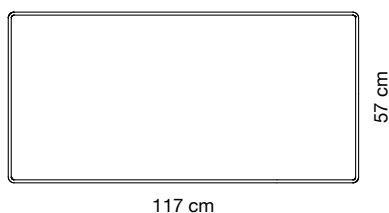

The products described in this data sheet are **CE marked** according to the harmonized product standard EN 13964 for the intended use as a drop ceiling.

Structure description:

Modular structure, made of chrome-plated steel, consisting of 25x20 mm rectangular-section tubular profiles and connecting corner joints, joined together by means of screws. The corner joint consists of 20x17 mm "C" profiles, welded together, and a \varnothing 12 mm tubular section fitted at the ends with threaded bushes. Cylindrical elements \varnothing 10 mm are attached to the sleeves, which allow the cables to be adjusted in height to the millimetre by means of a pressure system with safety lock. The structure is completed at the ends with closed-head end elements made of 25x20 mm chrome-plated steel tubing. Connection to the ceiling is by means of four \varnothing 1.5 mm steel cables and four \varnothing 40 mm chrome-plated steel circular plates with two holes for the ceiling anchoring screws.

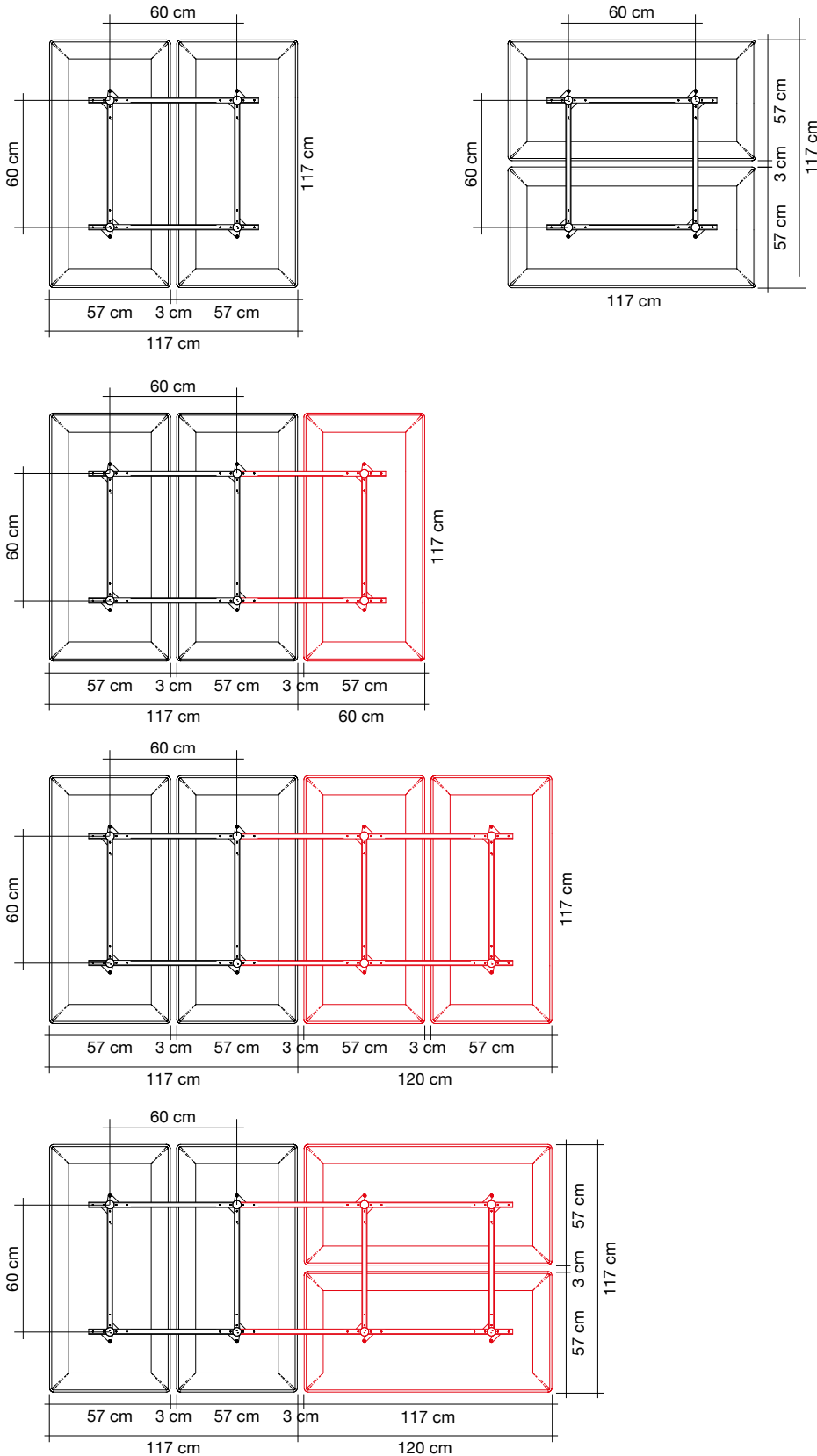

Available colors:

0012



White

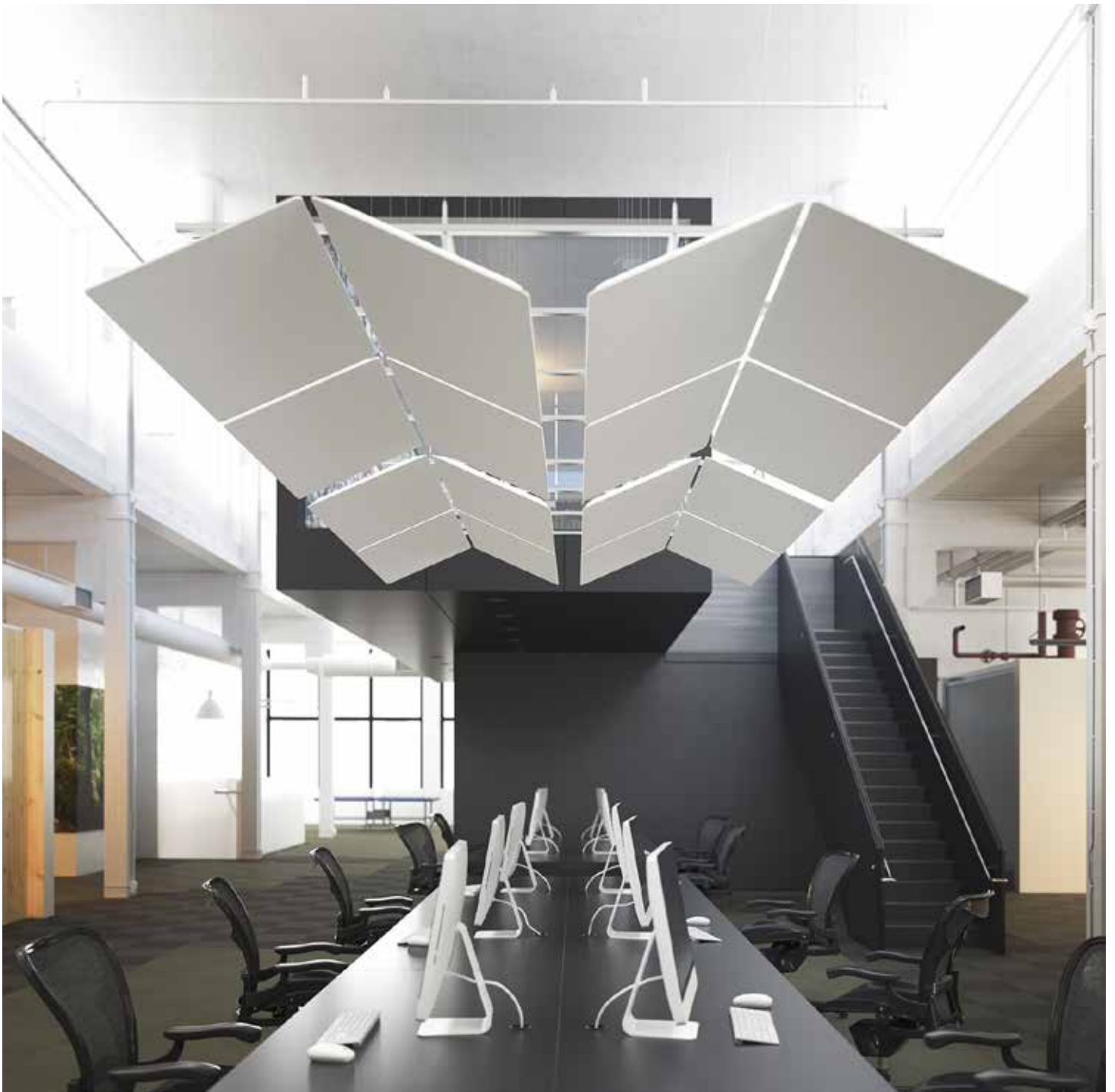

Caimi Brevetti S.p.A. reserves, by its unappealable judgment, the right to modify without prior notice the building materials, the technical and aesthetic specifications, as well as the dimensions of the products in this technical sheet, where pictures are purely as an indication.